

35m - 1.400kg

30m - 1.600kg

23m - 1.800kg

18m - 2.000kg

I

II

III

IV

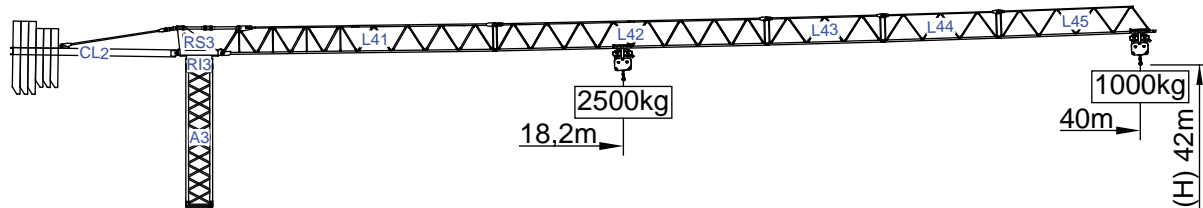

Cargas.Loads.Lasten.Charges.Cargas.Carichi.Yükler.ГРУЗОПОДЪЕМНОСТЬ

Icon	Diagram	Kg/m M/KT 2500	m	Kg					
				14	18	23	30	35	40
10500 kg 3x2000+3x1500 kg	40m	L41+L42+L43 L44+L45	18,2 m	2500	2500	1900	1400	1100	1000
9000 kg 3x2000+2x1500 kg	35m	L41+L42+L43+L45	21 m	2500	2500	2200	1600	1400	
7500 kg 3x2000+1x1500 kg	30m	L41+L42+L45	20,2 m	2500	2500	2100	1600		
4500 kg 3x1500 kg	23m	L41+L44+L45	17,1 m	2500	2300	1800			
4500 kg 3x1500 kg	18m	L41+L45	14,7 m	2500	2000				

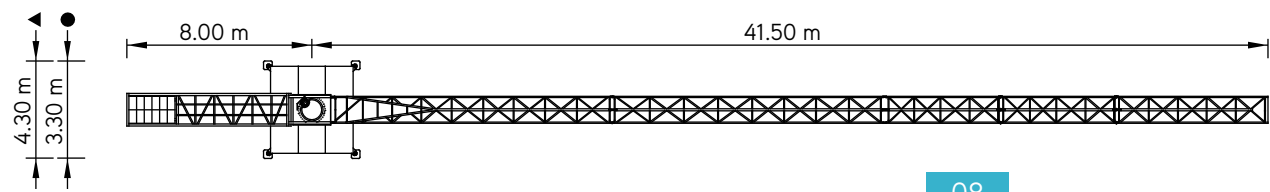
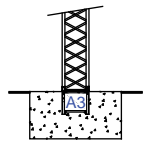
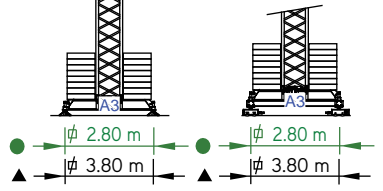





SGT 4010TL



40m - 1.000kg

2.500kg

Características . Characteristics . Eigenschaften
Caractéristiques . Characteristics . Caratteristiche
Özellikler . ХАРАКТЕРИСТИКИ

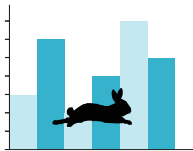
	
	0 a 1 r.p.m. 5 daN.m
	0 a 50 m/min 1,5 kW
	15 m/min 2x3 kW



	
	0 a 53 m/min 11 kW

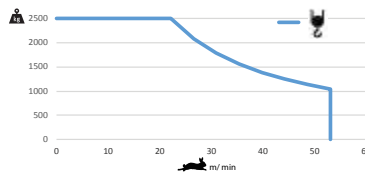



	23 kVA 400 V +- 5% (50/60 Hz)
---	----------------------------------

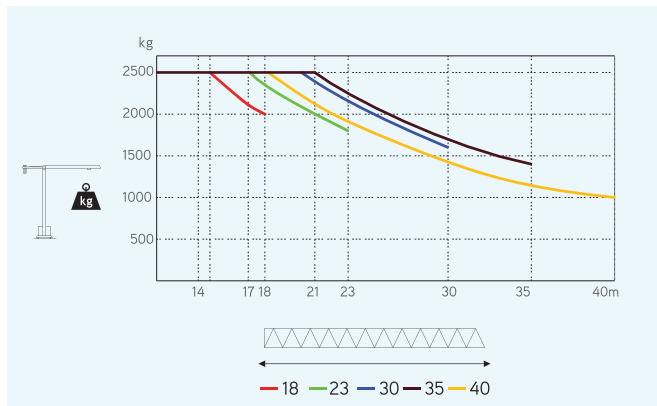

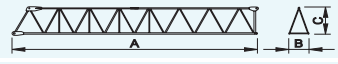
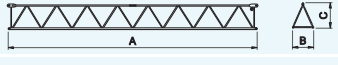
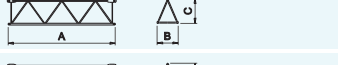
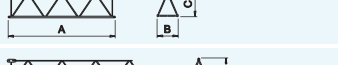
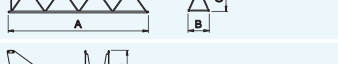

Velocidade de elevação . Hoisting speed . Hubgeschwindigkeit . Vitesse d'élevation .
Velocidad de elevación . Velocità di sollevamento . Kaldırma hızı (m/min) .
Скорость подъема (м/мин)

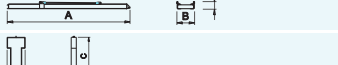
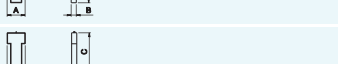
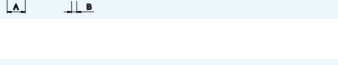

Elementos . Parts . Teile . Éléments . Elementos . Elemento . Parçalar . ЭЛЕМЕНТЫ

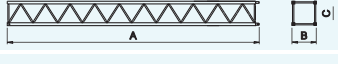

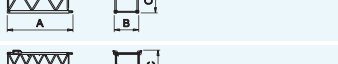
		A (mm)	B (mm)	C (mm)	kg	Code	
L41		11860	1350	1850	2400	509 40 10	
L42		11820	1160	1210	820		
L43		5100	1160	1210	260		
L44		5100	1160	1210	230		
L45		6800	1160	1210	290		
RS3 RI3		2130	1310	1830	2120		
CL2		7260	1220	500	1370		
CP1		1160	320	2530	3x1500 4500		704 15 00
CP2		1160	330	3140	3x2000 6000		704 20 00

TOTAL 17990

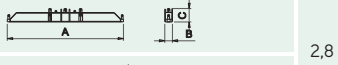
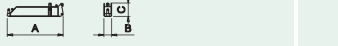
A3		11985	1180	1180	2450	504 12 02
A3		6075	1180	1180	1300	504 06 00
A3		3120	1180	1180	720	504 06 01
A3		3120	1385	1380	810	504 06 03
A3		1200	1160	1160	350	504 06 02

A3		2,8	4135	500	635	835	606 00 11
			2025	360	635	2x390 780	

TOTAL 1615

A3		3,8	5525	500	635	1075	604 00 01
			2670	360	635	2x535 1070	

TOTAL 2145